

## Graduated rings

Steel, matt chrome plated / blank

### SPECIFICATION

#### Types

Type **MCR**: matt chrome plated

Type **MCRS**: matt chrome plated, standard scale 0...90,

100 graduations, acc. scale scheme d1/100 A RA 0-10-20...90/10

Steel

- Scale lug d1 fine turned
- blank (standard version)
- matt chrome plated **MCR**
- matt chrome plated with standard scale **MCRS**

Scale

engraved with laser precision, black

### INFORMATION

Besides the standard scale (Type MCRS) the scale rings can be supplied with any type of graduation. It is suggested to use the matt chrome plated version (MCR) so that a nice discrepancy in colour is given.

Regarding design, numbering run, numbering position and numbering sequence of the scale please see the layout for scale rings on the order sheet "How to order Graduations" (see page 594).

### ON REQUEST

- special graduations see "How to order graduations" (see page 594)

### TECHNICAL INFORMATION

- ISO-Fundamental Tolerances (see page A21)

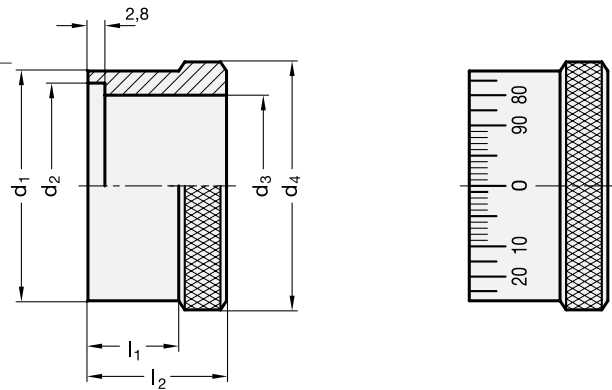

### GN 264

Description	d1	d2	d3 H7	d4	l1	l2	Scaling set consists of: 1 Scale ring 2 Collar bushes	Scaling set consists of: 1 Scale ring 3 Flat springs	⚖
GN 264-30	30	27	24	33	16	23.7	GN 268-24-K...	GN 374-0.3-10	49
GN 264-40	40	36	32	43	16	23.7	GN 268-32-K...	GN 374-0.4-10	86
GN 264-60	60	55	50	63	16	25.7	GN 268-50-K...	GN 374-0.6-10	177
GN 264-80	80	75	68	83	16	25.7	GN 268-68-K...	GN 374-0.8-10	282

### GN 264-MCR/MCRS

Description	d1	d2	d3 H7	d4	l1	l2	Scaling set consists of: 1 Scale ring 2 Collar bushes	Scaling set consists of: 1 Scale ring 3 Flat springs	⚖
GN 264-30-MCR	30	27	24	33	16	23.7	GN 268-24-K...	GN 374-0.3-10	58
GN 264-30-MCRS	30	27	24	33	16	23.7	GN 268-24-K...	GN 374-0.3-10	58
GN 264-40-MCR	40	36	32	43	16	23.7	GN 268-32-K...	GN 374-0.4-10	86
GN 264-40-MCRS	40	36	32	43	16	23.7	GN 268-32-K...	GN 374-0.4-10	86
GN 264-60-MCR	60	55	50	63	16	25.7	GN 268-50-K...	GN 374-0.6-10	177
GN 264-60-MCRS	60	55	50	63	16	25.7	GN 268-50-K...	GN 374-0.6-10	177
GN 264-80-MCR	80	75	68	83	16	25.7	GN 268-68-K...	GN 374-0.8-10	282
GN 264-80-MCRS	80	75	68	83	16	25.7	GN 268-68-K...	GN 374-0.8-10	282

